

Important safety instructions:

- Please carefully read all instructions before assembling.
- For your safety and ease, assembly by two or more adults is recommended.
- Keep instructions for future use.

Pre-assembly:

- Do not discard any contents until after assembly is complete to avoid accidentally discarding small parts or hardware.
- Remove all parts and hardware from box along with any plastic protective packaging.

Parts List

Item	Description	QTY
P1	Chair Top	1
P2	Front Legs	2
P3	Back Legs	2

Hardware List

Item	Description	QTY
H1	Bolts Ø5/16"x2"	8
H2	Lock Washers 5/16"	8
H3	Flat Washers 5/16"	8
H4	Allen Wrench 5/16"	1

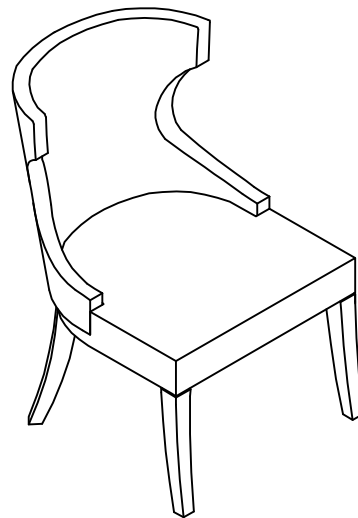

Assembly Procedures:

Step 1. Assembly the chair on a flat, soft surface such as a carpet or cloth to prevent scratching the finish.

- 1) Loosely attach the front/back legs (P2, P3) to the chair top (P1) following the labels "P2", "P3" on each leg and the bottom of seat cushion accordingly and using bolts (H1), lock washers (H2) and flat washers (H3) as shown below.
- 2) Make sure the chair is level and securely tighten all bolts with Allen wrench (H4).
- 3) Assembly is complete. **Failure to follow these instructions may cause the bolts to misalign during assembly.**

- (H1)x8 Bolts 
- (H2)x8 Lock Washers 
- (H3)x8 Flat Washers 
- (H4)x1 Allen Wrench 

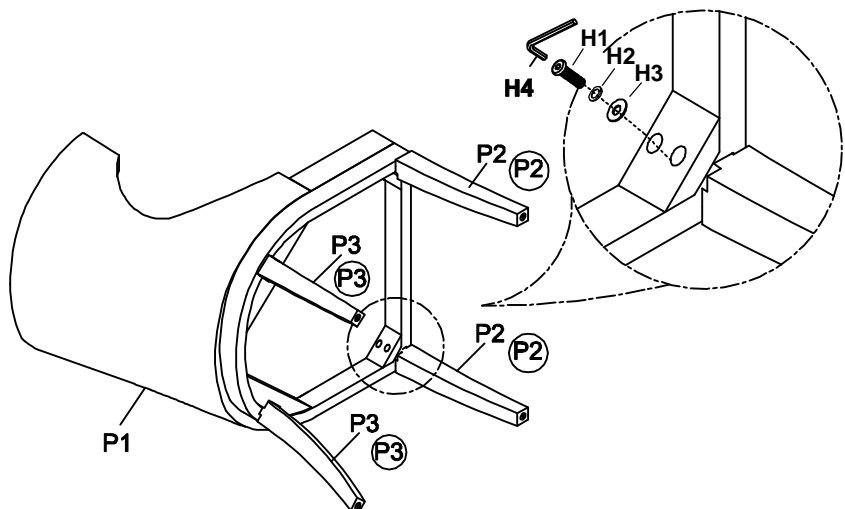

ADDITIONAL NOTE ABOUT SAFETY: BOLTS MAY LOOSEN DURING NORMAL EVERYDAY USE. THEY SHOULD BE PERIODICALLY INSPECTED AND RE-TIGHTENED TO PREVENT DAMAGE OR INJURY. ALWAYS CHECK TO BE SURE THAT ALL HARDWARE IS KEPT TIGHTENED.

Thank you for your purchase