

Step 3. Attach one leg (C) to the seat cushion (B) according the label on the top of left leg and the corner block, using bolts (a), lock washers (c) and flat washers (d). Loosely tighten with Allen wrench (e). Repeat this step to attach another leg (C).

Step 3

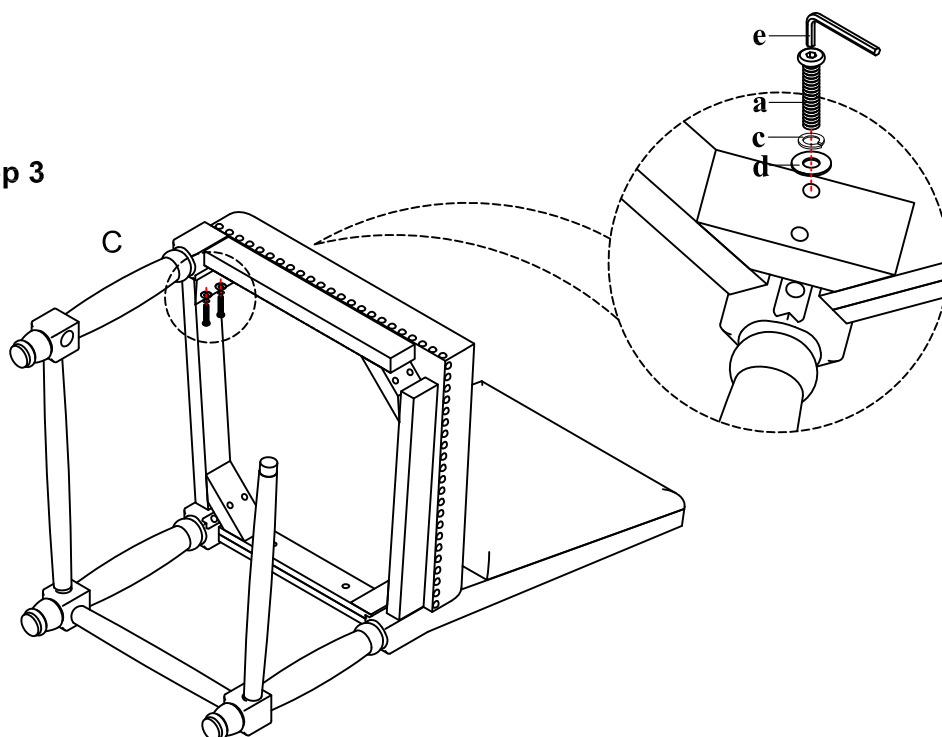

Step 4.

- 1). Insert front stretcher (D) between the two legs (C).
- 2). Securely tighten all bolts with allen wrench (e), but do not over tighten the bolts. Tighten screws (f) through the stretchers (D) & (E) to the legs (C) and chair back legs with screwdriver (not provided).

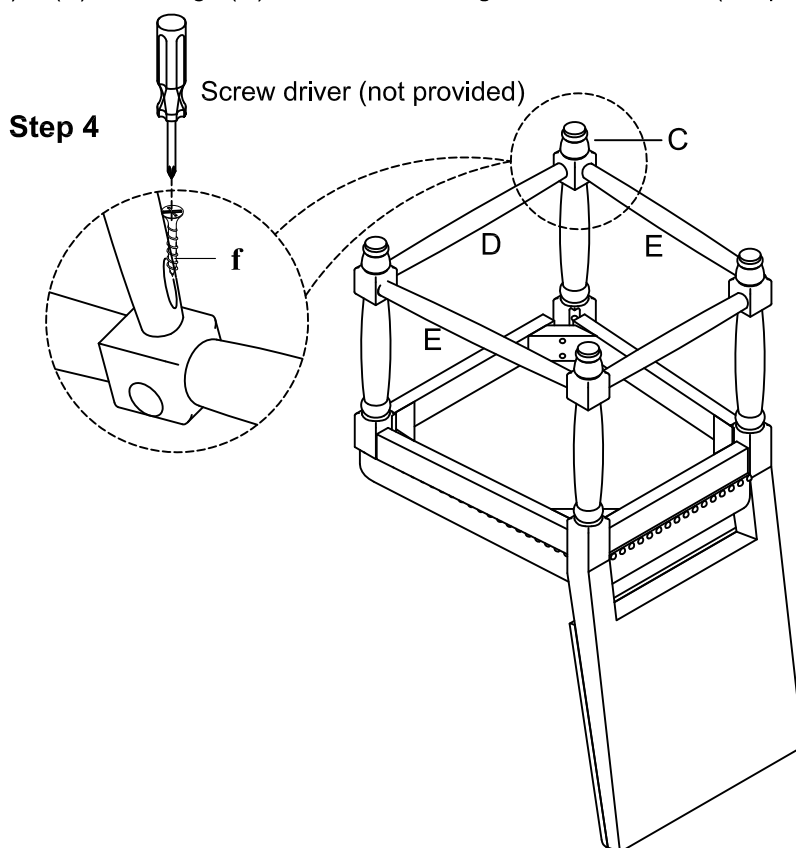

Thank you for your purchase