

ASSEMBLY INSTRUCTIONS

Description: Crackle 48" Round Table

Important safety instructions:

- Please carefully read all instructions before assembling the table.
- For your safety and ease, assembly by two or more adults is recommended.
- Keep instructions for future use.

Pre-assembly:

- Do not discard any contents until after assembly is complete to avoid accidentally discarding small parts or hardware.
- Remove all parts and hardware from box along with any plastic protective packaging.

Parts List

Item	Description	QTY
A	Table top	1
B	Mounting plate	1
C	Base	1

Hardware List

Item	Description	QTY
a	Bolts Ø5/16*1-3/8"	4
b	Lock Washers 5/16"	4
c	Flat Washers 5/16"	4
d	Allen Wrench 5/16"	1

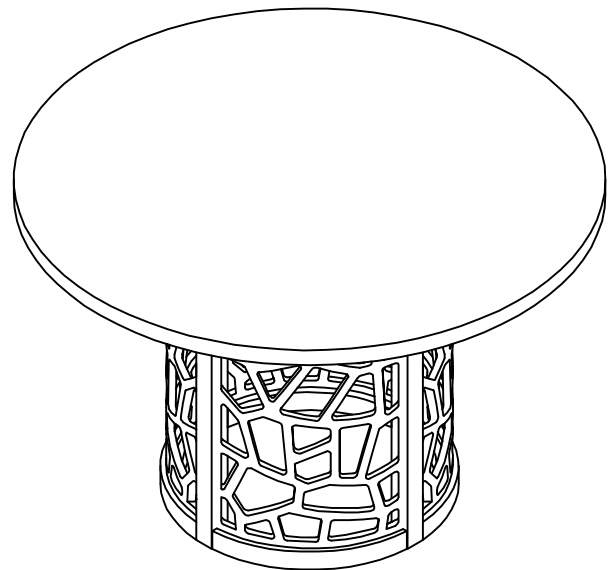

Assembly Procedures:

Step 1. Assemble the table on a flat, soft surface such as a carpet or cloth to prevent scratching the finish. Remove the mounting plate (B) from the bottom of table top (A) by unscrewing the bolts (a), lock washers (b) and flat washers (c) by Allen wrench(d) on the mounting plate under the table top . Do not throw away the hardware.

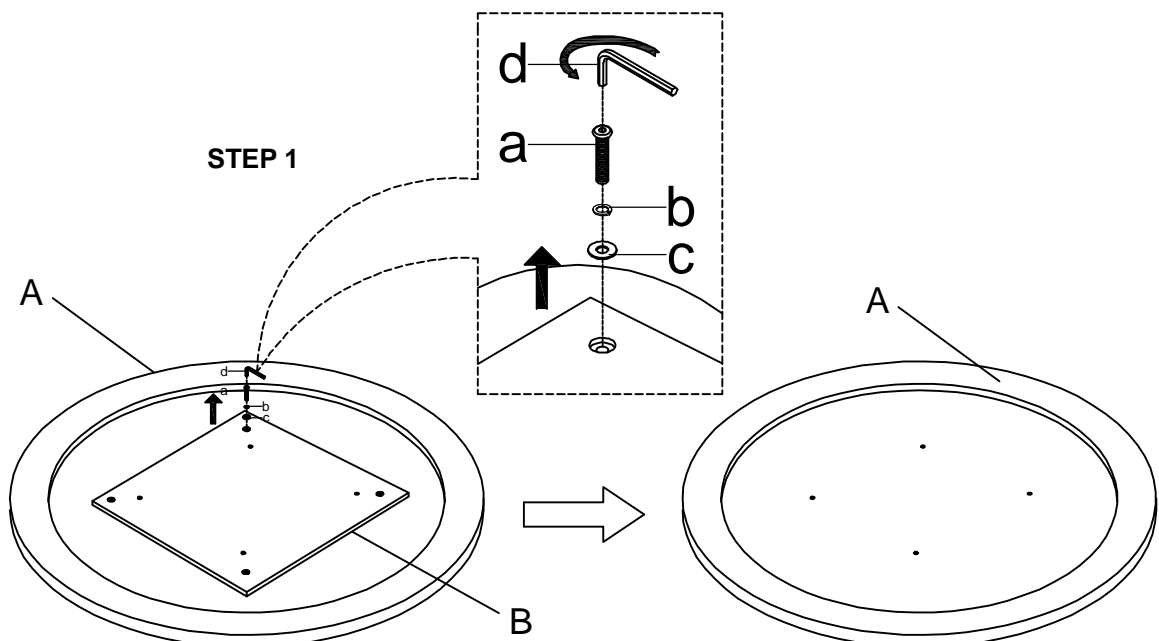

Step 2. Attach the mounting plate (B) to the base (C) using bolts (a), 5/16" lock washers (b) and 5/16" flat washers (c). Securely tighten all bolts by Allen wrench (d), but do not over tighten the bolts.

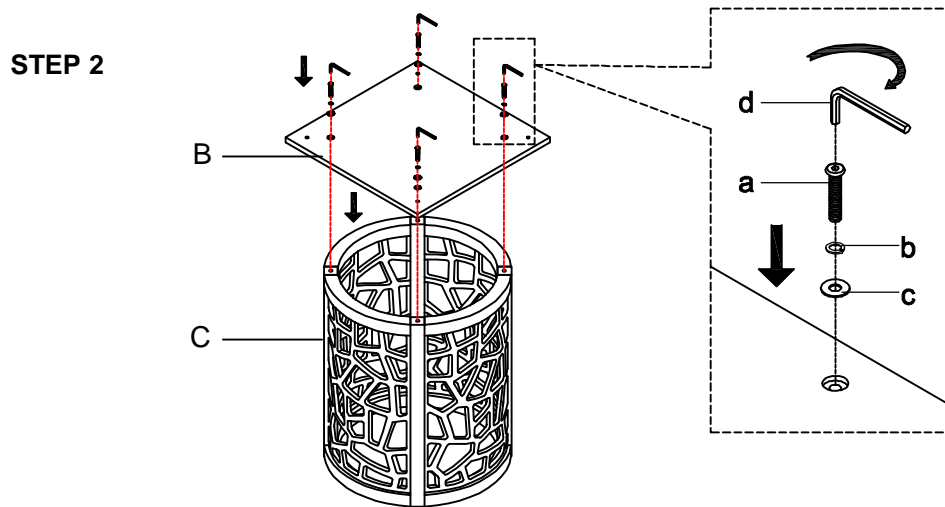

Step 3. Turn the table top (A) upside down on a flat, soft surface such as a carpet or cloth to prevent scratching the finish. Attach assembled the base(C) and mounting plate (B) to the table top (A) using bolts (a), 5/16" lock washers (b) and 5/16" flat washers (c). Securely tighten all bolts by Allen wrench (d), but do not over tighten the bolts.

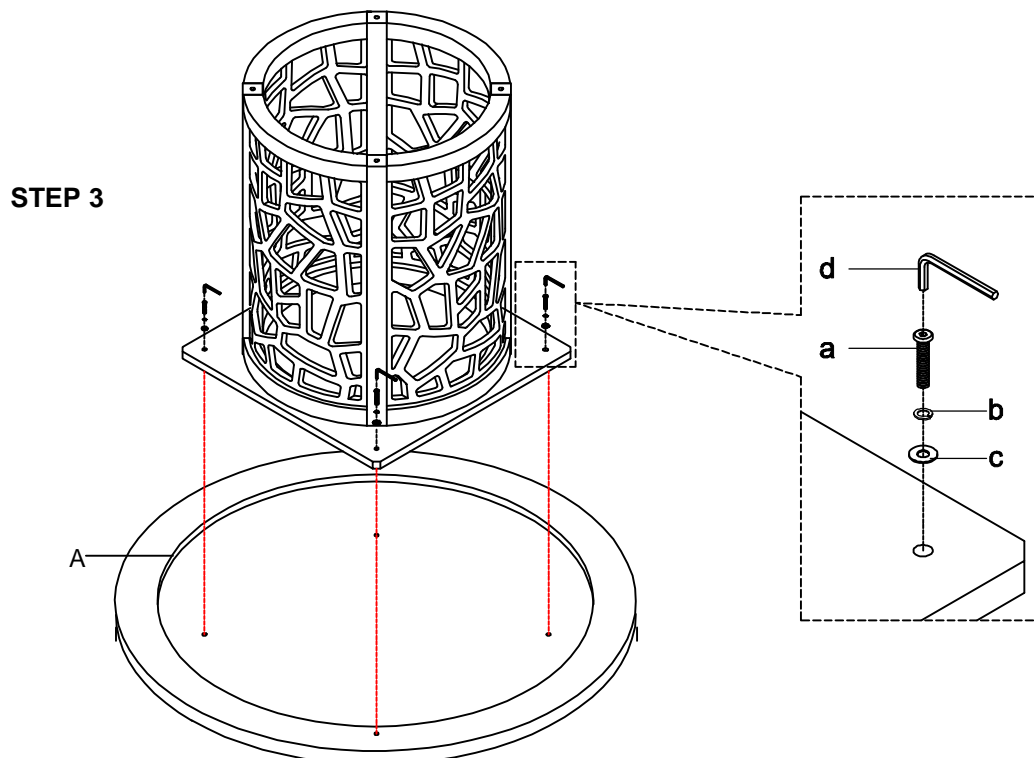

Step 4 . Turn the assembled table to an upright position.
Assembly are complete.

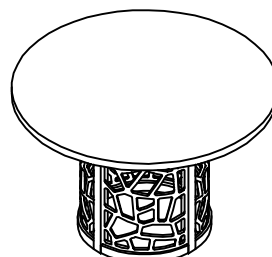

Thank you for your purchase