

MONTEREY SHELF - OPTION 1

Assembly instructions:

PARTS LIST

No.	DESCRIPTION	IMAGE	QTY
P1	TOP SHELF		1
P2	SHELVES		4
P3	VERTICAL PANEL		8
P4	LEG		4

HARDWARE LIST

No.	DESCRIPTION	IMAGE	QTY
H1	BOLT (Ø6x80 MM)		36
H2	SPRING WASHER		36
H3	ALLEN KEY		1

NOTE: PO# is located underneath/ inside of each item. Please be prepared to provide this # should any claim be necessary.

CAUTION: Item is heavy assembly should be performed by two people.

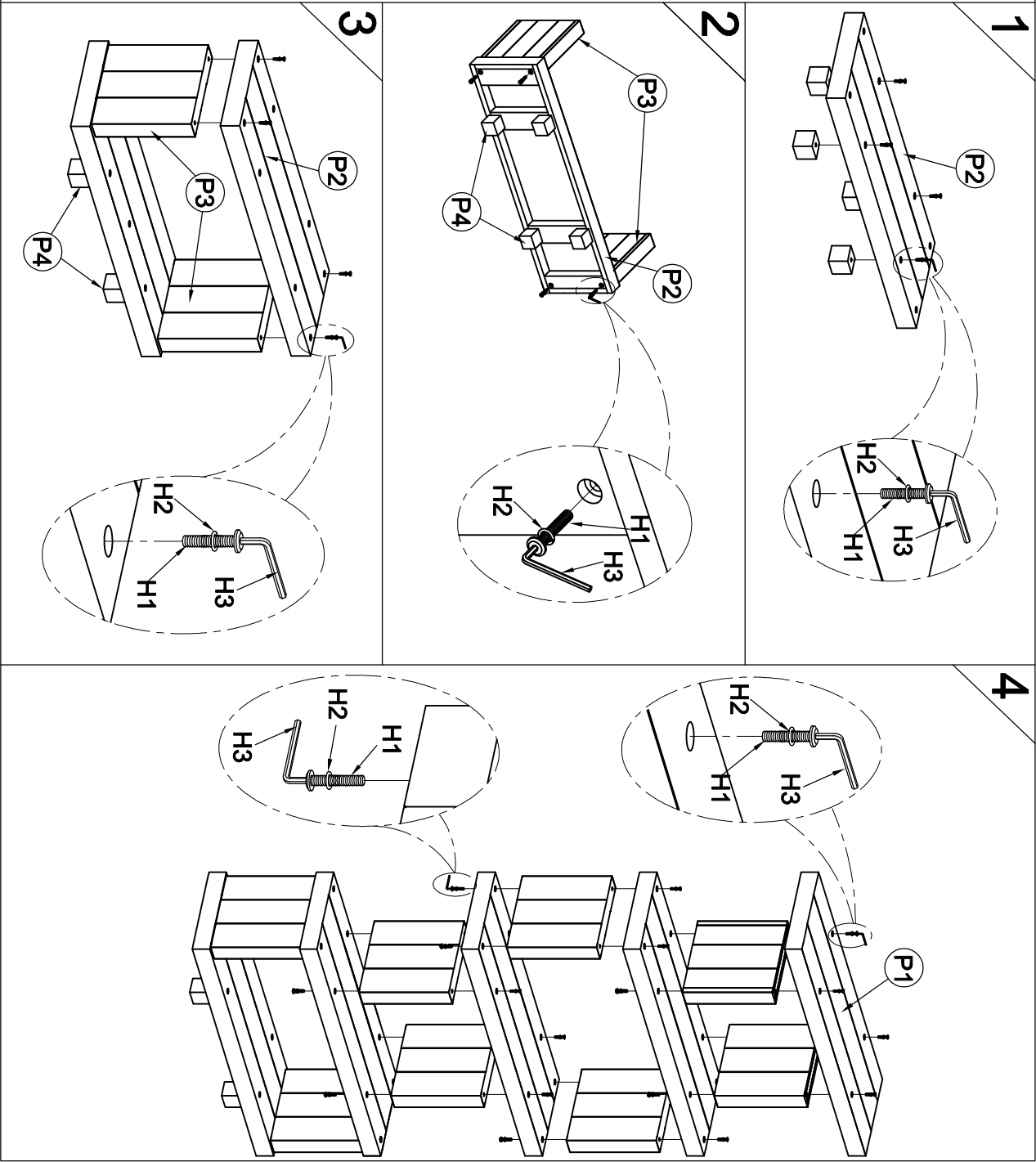

MONTEREY SHELF - OPTION 2

Assembly instructions:

<p>1</p> <p>Diagram showing the first step of assembly: attaching a shelf board (P2) to a support rail (P3) using a bolt (H1), washer (H2), and nut (H3).</p>	<p>4</p> <p>Diagram showing the fourth step of assembly: completing the assembly by attaching the final shelf board (P1) to the support rail (P3) using a bolt (H1), washer (H2), and nut (H3).</p>	<p>OPTION 1</p> <p>Diagram showing the final assembly view for Option 1, which is a three-tier shelf.</p>
<p>2</p> <p>Diagram showing the second step of assembly: attaching a shelf board (P2) to a support rail (P3) using a bolt (H1), washer (H2), and nut (H3).</p>	<p>OPTION 2</p> <p>Diagram showing the final assembly view for Option 2, which is a four-tier shelf.</p>	<p>OPTION 2</p> <p>Diagram showing the final assembly view for Option 2, which is a four-tier shelf.</p>
<p>3</p> <p>Diagram showing the third step of assembly: attaching a shelf board (P2) to a support rail (P3) using a bolt (H1), washer (H2), and nut (H3).</p>	<p>OPTION 2</p> <p>Diagram showing the final assembly view for Option 2, which is a four-tier shelf.</p>	<p>ASSEMBLY COMPLETED</p> <p>Diagram showing the final assembly view for Option 2, which is a four-tier shelf.</p>