

## Important safety instructions:

- Please read carefully all instructions before assembly.
- For your safety and ease, assembly by two or more adults is recommended.
- Keep instructions for future use.

## Pre-assembly:

- Do not discard any content until assembly is complete to avoid accidentally discarding small parts or hardware.
- Take out all parts and hardware from box.

## Parts List

NO	DESCRIPTION	IMAGE	QTY
P1	TOP		1
P2	LEFT LEG		1
P3	RIGHT LEG		1
P4	STRETCHER		1

## Hardware List

NO	DESCRIPTION	IMAGE	QTY
H1	BOLT ( M6 x 80mm )		6
H2	ALLEN KEY		1
H3	CROSS DOWEL BARREL NUTS		6
H4	WASHER SPRING		6
H5	WASHER		6
H6	WOODEN PLUG		6

## DISCLAIMER:

WHEN PROPERLY ASSEMBLED, THIS ITEM IS SAFE FOR INTENDED USE. SELLER IS NOT LIABLE FOR ANY DAMAGES RESULTING FROM ITEM BEING IMPROPERLY ASSEMBLED AFTER PURCHASE.

## Assembly Procedures:

### Step 1:

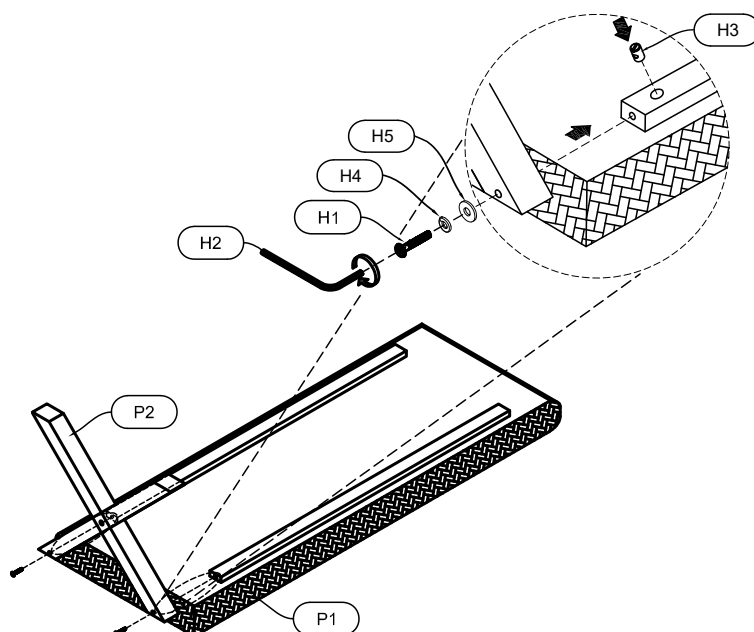

# ASSEMBLY INSTRUCTIONS

Description: SEADRIFT BENCH

Step 2:

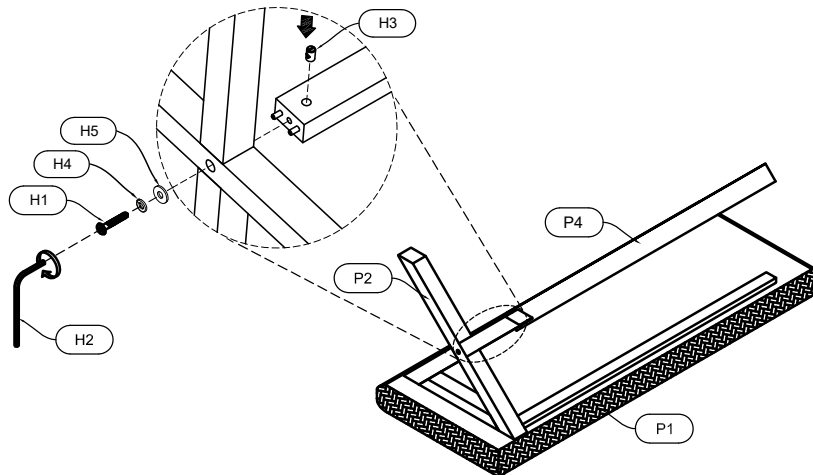

Step 3 :

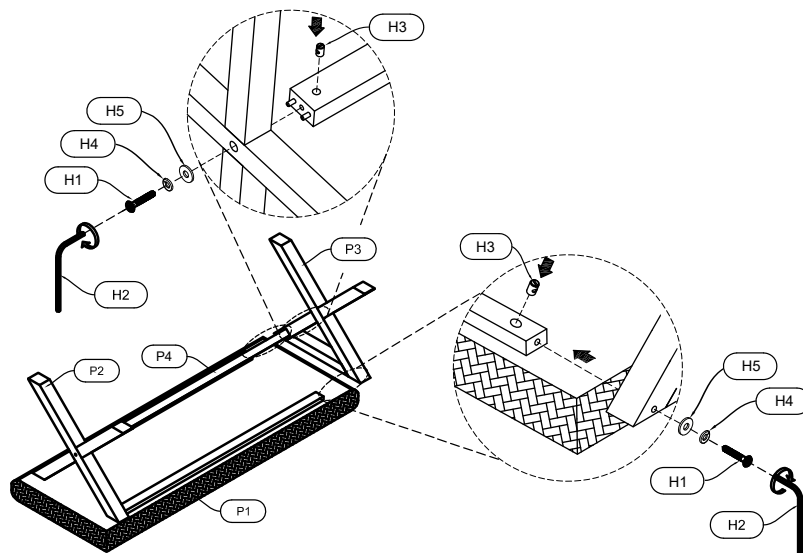

Step 4 :

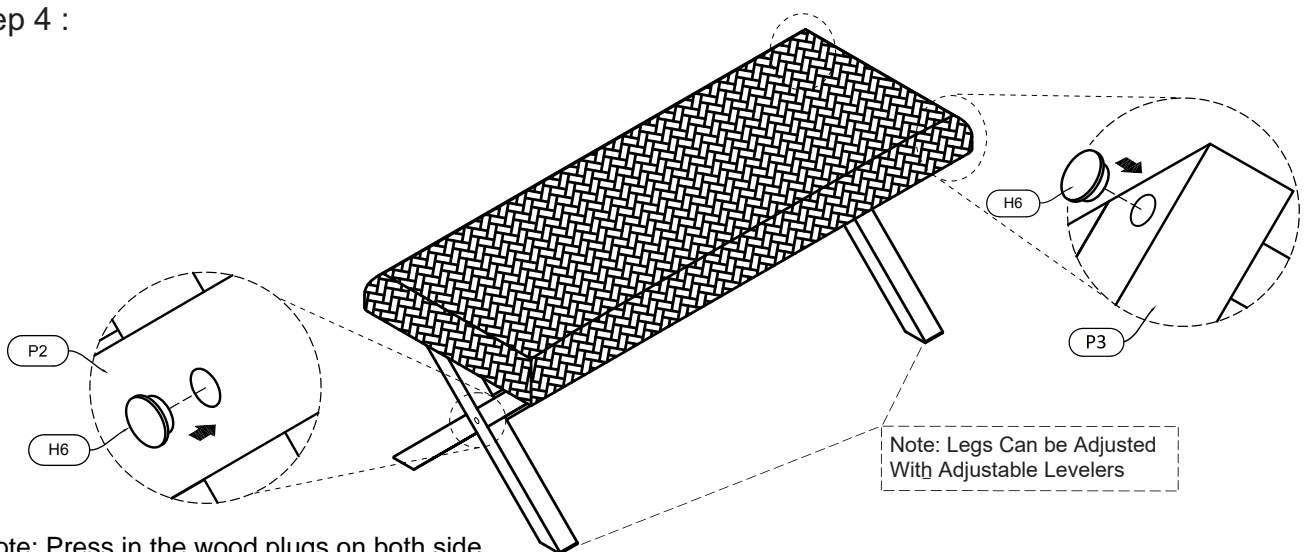

**ASSEMBLY COMPLETED**

## ADDITIONAL NOTE ABOUT SAFETY:

BOLTS MAY LOOSEN DURING NORMAL EVERYDAY USE.

THEY SHOULD BE INSPECTED AT LEAST EVERY 3 MONTHS AND RE-TIGHTENED AS NEEDED TO PREVENT DAMAGE OR INJURY, AND ENSURE STABILITY.

Thank you for your purchase