



## Part List

No.	DESCRIPTION	IMAGE	QTY
P1	Chair Body		1
P2	Legs		2
P3	Seat Cushion		1
P4	Back Cushion		1

## Hardware List

No.	DESCRIPTION	IMAGE	QTY
H1	Long Bolt	 Φ5/16"*1-1/2"	8
H2	Allen wrench	 1/5"	1
H3	Flat Washer	 Φ5/16"	8
H4	Spring washer	 Φ5/16"	8

NOTE:PO# is located underneath/inside of each item.  
Please be prepare to provide this# should any claim be necessary.  
CAUTION:Item is heavy assembly should be performed by two people.  
Estimate assembly time:5 minutes.

Step 1: Take out the legs under the cushion.

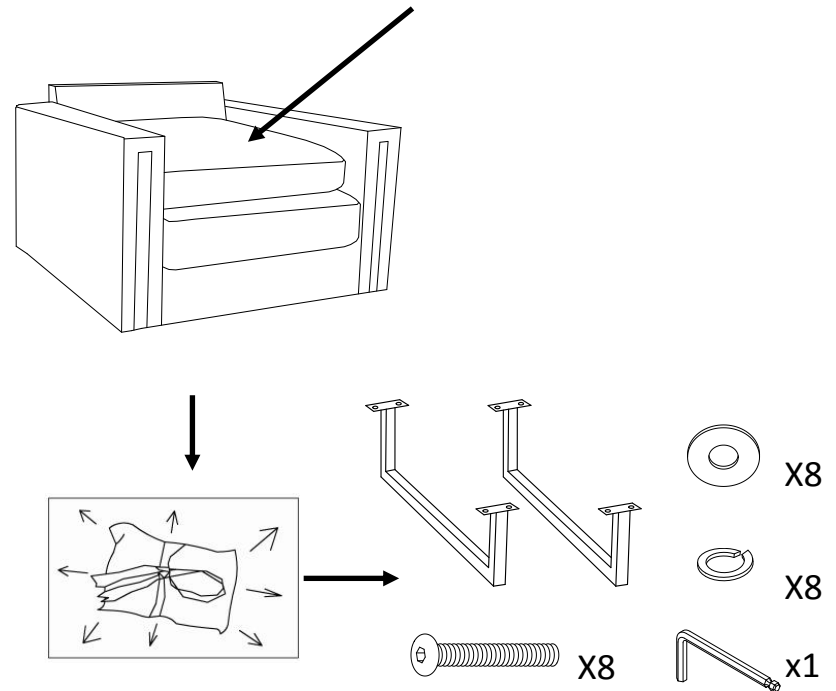

Step 2: Attach legs(P2) to the seat frame by using flat washer (H3),spring washer(H4), Long Bolt (H1)and use Allen wrench(H2)to tighten the bolt !

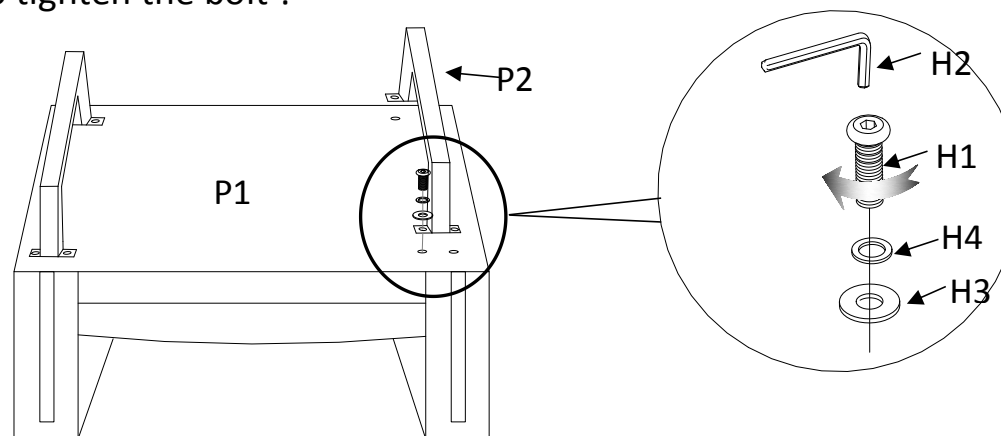

Step 3: Level the chair and place the chair upright on a level surface.

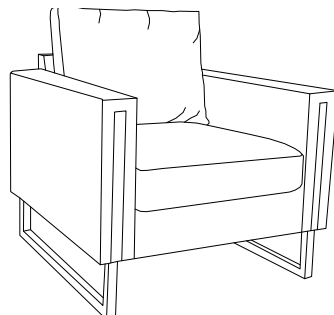

**ADDITIONAL NOTE ABOUT SAFETY: BOLTS MAY LOOSEN DURING NORMAL EVERYDAY USE. THEY SHOULD BE PERIODICALLY INSPECTED AND RE-TIGHTENED TO PREVENT DAMAGE OR INJURY. ALWAYS CHECK TO BE SURE THAT ALL HARDWARE IS KEPT TIGHTENED.**

**Thank you for your purchase**