

Important safety instructions:

- Please read carefully all instructions before assembling the accent chair.
- For your safety and ease, assembly by two or more adults is recommended.
- Keep instructions for future use.

Pre-assembly:

- Do not discard any content until assembly is completed to avoid accidentally discarding small parts or hardware.
- Remove all parts and hardware from box.

Parts List

Item	Description	DRAWING	QTY
P1-1	Corner chair		1
P2-1	Backrest		1
P3	Cushion		1
P4	Legs		4
P5	Backrest		1
P6	Cushion		1

Hardware List

Item	Description	DRAWING	QTY
H1	Bolts ϕ 5/16"1"		16
H2	Bolts ϕ 5/16"2-4/5"		10
H3	Lock Washers ϕ 5/16"		26
H4	Flat Washers ϕ 5/16"		26
H5	Allen Wrench		1
H6	foot pad		4
H7	Bolts ϕ 5/16"2-1/5"		1
H8	Flat Washers ϕ 5/16" small external diameter		1
H9	Wood Plug		1

DISCLAIMER:

WHEN PROPERLY ASSEMBLED, THIS ITEM IS SAFE FOR INTENDED USE. SELLER IS NOT LIABLE FOR ANY DAMAGES RESULTING FROM ITEM BEING IMPROPERLY ASSEMBLED AFTER PURCHASE.

Assembly Procedures:

Step 1. Assemble the chair on a flat, soft surface such as carpet or cloth to prevent scratching the finish. Remove all parts and hardware from box.

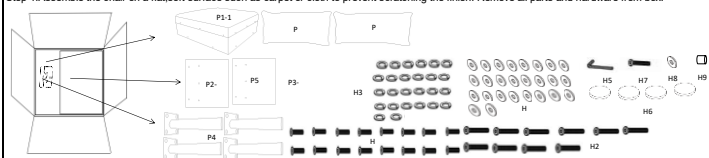

Step 2. Place Backrest(P2) flat on a soft mat. Using bolts(H2), lock washers(H3), flat washers(H4), connect backrest(P2-1) to chair(P1-1). Tighten bolts(H2) with allen wrench (H5).

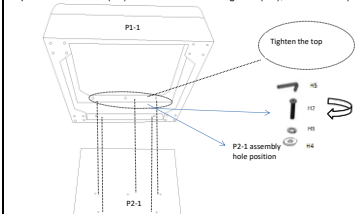

Step 3. Using bolts(H2), lock washers(H3), flat washers(H4), connect backrest(P5) to chair(P1-1). Tighten bolts(H2) with allen wrench (H5).

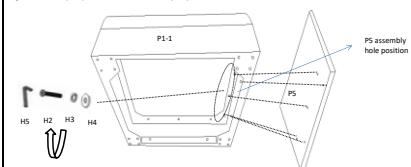

Step 5. Using bolts (H7), flat washers(H8), connect backrest(P2-1) and backrest (P5). Tighten bolts (H7) with allen wrench (H5). Place the wood plug(H9) into the hole as illustration.

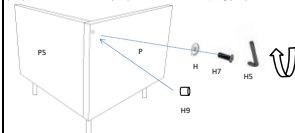

Step 7. If want a combination installation, Using bolts (H1), lock washers (H3), flat washers (H4), chair legs(P4) to chair (P1). Tighten bolts (H1) with allen wrench (H5). When combined, the elliptical holes of P4 must be kept horizontally, as shown in the figure. If the upside-down backrest is not flat after foot assembly, glue footpads(H6) on the four outer feet as shown in the picture.

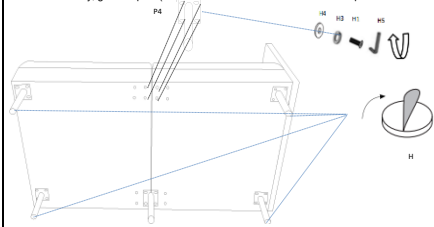

ADDITIONAL NOTE ABOUT SAFETY: BOLTS MAY LOOSEN DURING NORMAL EVERYDAY USE. THEY SHOULD BE PERIODICALLY INSPECTED AND RE-TIGHTENED TO PREVENT DAMAGE OR INJURY. ALWAYS CHECK TO ENSURE THAT ALL HARDWARE IS KEPT TIGHTENED.

Thank you for your purchase

Step 4. Using bolts (H1), lock washers (H3), flat washers (H4), connect legs(P4) to chair (P1-1). Tighten bolts (H1) with allen wrench (H5).

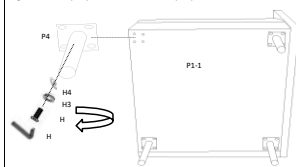

Step 6. Place chair upright on a level surface. Assembly is complete.



Step 8. Place chair upright on a level surface. Assembly is complete.

